

CERTIFICATE OF LOCATION OF GOVERNMENT CORNER

21 MEANDER Corner of Section 18, Township 107 N, Range 39 W, 5 th. P.M.

STATE OF MINNESOTA, County of MURRAY

At the corner location shown on the sketch

- On _____ found a _____
- DATE
- left monument as found, lowered monument, removed monument (explain)
- On 10-9-91 placed a 3/4" x 24" REBAR WITH ALUMINUM CAP STAMPED
- DATE "DNR SURVEY MARKER", UP 0.1' FOR A REF. MONUMENT

SKETCH OF REFERENCE TIES

NOTE:
 MONUMENT IS
 ON TOP OF LAKE BANK

 GOOD TIES NOT AVAILABLE

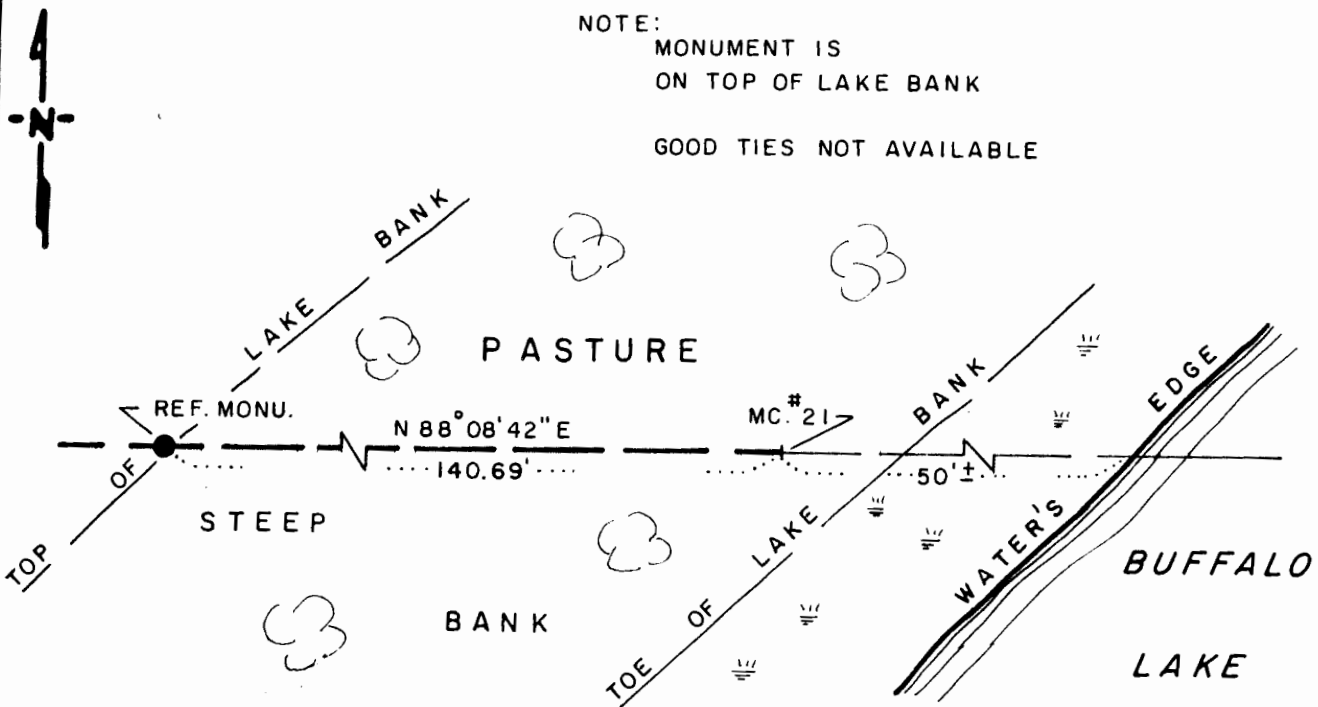

1983 MURRAY COUNTY COORDINATE SYSTEM	
MEANDER COR. # 21 N = 184,574.784 E = 548,544.913	REF. MONUMENT N = 184,570.229 E = 548,404.299

BEARINGS ARE IN COUNTY ORIENTATION

Statement of evidence relative to this corner location is on back of page

J.B.M. 11-26-91
WMA 00065.00.00.01

I hereby certify that this document and the data contained herein was prepared by me or under my direct supervision.

Bruce W. Shopp 12-2-91

REGISTRAR DATE

Registration No. 17003

Land Surveyor, Professional Engineer

County Surveyor, County Engineer

OFFICE OF THE COUNTY RECORDER
 County of MURRAY

I hereby certify that this document was filed in the Co. Recorder's office at _____ M. on the _____ day of _____ A.D., 19__

County Recorder James V. Johnson

By DEC 4 1991, Deputy

DOCUMENT NO. _____

Meander Corner Number 21 of Section 18, Township 107 North, Range 39 West

The DNR Bureau of Engineering contacted the following for survey information:

Minnesota Secretary of State's Office
Murray County Recorder's Office
Murray County Highway Engineer's Office

- 1861 U.S. General Land Office notes obtained from the Secretary of State's Office show the corner marked with a wood post with the following bearing trees marked:
7" Br. Oak, North $69-1/2^{\circ}$ East, 63 links (41.58 feet)
7" Elm, South $87-1/2^{\circ}$ West, 48 links (31.68 feet)
- 1907 Surveyor's Record Book A, page 205, obtained from the County Recorder's Office contains a survey by J. W. Woolstencraft. Survey shows a lake in the northwest quarter of Section 18 but does not show corner.
- 1991 October, DNR Bureau of Engineering searched area of corner for occupation lines and evidence of the GLO bearing trees but found nothing. Computed the lost position for corner and found it to be:
on a steep lake bank
50 feet westerly of the water's edge
182.99 feet (181.50' GLO) from the northeast corner of Section 13
1519.13 feet (1506.78' GLO) from Meander Corner Number 22

Analysis of the above information led the DNR Bureau of Engineering to conclude that the computed lost position for corner marks its location. Set a reference monument to corner as shown on the sketch of reference ties.